

343 Bocchettone curvo FF

Union conical elbow F/F
Winkel Kupplung I/I
Coude union FF
Enlace 3 piezas curva HH

Materiale: AISI 316 / W. 1.4401
Filettatura: ISO 7/1 (ex DIN 2999)
Rating: 150 PSI – PN10

Codice	DN	DN inch	L1 mm	L2 mm	T mm	SW mm	Peso gr
343104316	8	1/4"	46,2	21	13,5	30	139
343308316	10	3/8"	49	25	15,5	35	164
343102316	15	1/2"	56	28	17	42	266
343304316	20	3/4"	62,7	33	19	47	364
343100316	25	1"	68	38	20,5	53	598
343114316	32	1" 1/4	79,5	45	23	71	1009
343112316	40	1" 1/2	88	50	26	77	1181
343200316	50	2"	93,8	58	28,5	92	1847

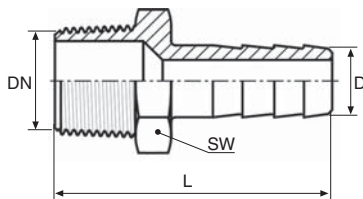

344 Portagomma M

Hose nipple
Schlauchnippel
Teton M
Entronque manguera

Materiale: AISI 316 / W. 1.4401
Filettatura: ISO 7/1 (ex DIN 2999)
Rating: 150 PSI – PN10

Codice	DN	DN inch	D mm	L mm	SW mm	Peso gr
344108316	6	1/8"	7	45	12,5	15
344104316	8	1/4"	9	47	16,5	31
344308316	10	3/8"	11	55	20	41
344102316	15	1/2"	13	64	23,5	71
344304316	20	3/4"	16	68	31	139
344100316	25	1"	25	71	38,5	235
344114316	32	1" 1/4	33	80	46	267
344112316	40	1" 1/2	39	95	52	412
344200316	50	2"	51	105	62	692